

---

# RUNTAL QUADRATO



**runtal**

# RUNTAL QUADRATO TECHNICAL SPECIFICATIONS

## CENTRAL HEATING VERSION

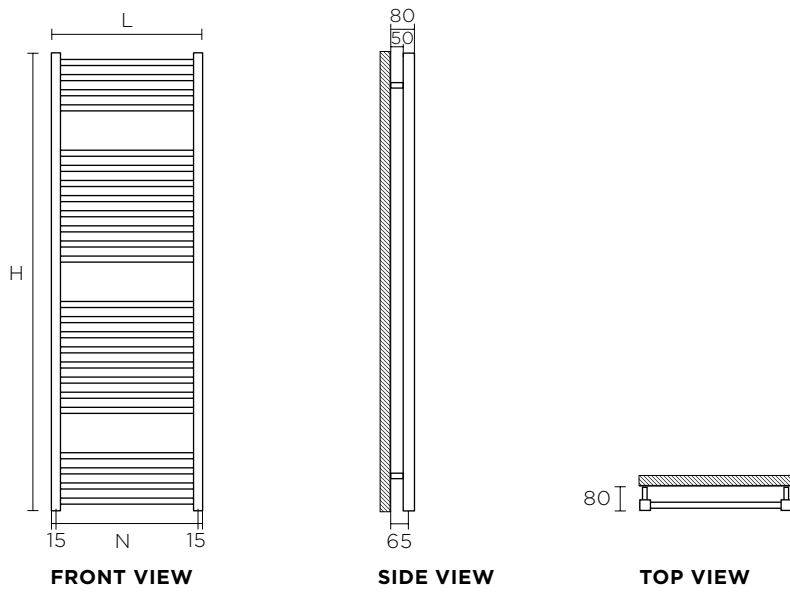

- H Height (mm)
- L Width (mm)
- N Pipe centres (mm)

# RUNTAL QUADRATO

## CENTRAL HEATING VERSION

Height 764 mm	Width mm	N mm	V dm <sup>3</sup>	M kg	n	P ΔT 50K Watt	LAMDA* Watt	Surface (Code)
QDR-075-050	500	470	3.1	7	1.25	340	300	RAL9016 (0603)
QDRC-075-050	500	470	3.1	7	1.31	272	300	Chrome (0790)
QDR-075-060	600	570	3.5	8	1.25	410	300	RAL9016 (0603)
QDRC-075-060	600	570	3.5	8	1.31	328	300	Chrome (0790)

Height 1164 mm	Width mm	N mm	V dm <sup>3</sup>	M kg	n	P ΔT 50K Watt	LAMDA* Watt	Surface (Code)
QDR-115-050	500	470	4.3	10	1.25	490	300	RAL9016 (0603)
QDRC-115-050	500	470	4.3	10	1.31	392	300	Chrome (0790)
QDR-115-060	600	570	4.9	11	1.25	580	300	RAL9016 (0603)
QDRC-115-060	600	570	4.9	11	1.31	464	300	Chrome (0790)

Height 1514 mm	Width mm	N mm	V dm <sup>3</sup>	M kg	n	P ΔT 50K Watt	LAMDA* Watt	Surface (Code)
QDR-150-050	500	470	5.7	13	1.25	600	600	RAL9016 (0603)
QDRC-150-050	500	470	5.7	13	1.31	480	600	Chrome (0790)
QDR-150-060	600	570	6.4	15	1.25	795	600	RAL9016 (0603)
QDRC-150-060	600	570	6.4	15	1.31	636	600	Chrome (0790)

N: pipe centres, V: volume, M: weight, n: exponent, PΔT 50K: EN442 output

\* LAMDA: max. recommended output of immersion heater for dual energy operation (electrical and central heating)

### Example of coding for order of product

<b>QDRC-075-050</b>	<b>0790</b>	<b>STAN</b>
model of radiator	colour code of finish	connection type/code

**TECHNICAL DATA**

Materials	Made of squared steel tubes, vertical tubes 30x 30 mm, horizontal tubes 20x20 mm, powder-coated in white RAL9016 (0603) or chrome plated (0790)
Operating pressure	Max. 8.0 bar
Test pressure	12 bar
Operating temperature	Max. 95 °C
Standard kit	Wall brackets in same colour as radiator, assembly kit included in packaging
Connections	With the standard $\varnothing$ 1/2" connections with internal thread, the following types of connections are possible. Flow $\blacktriangle$ / $\nabla$ return at choice on left-or right-hand at bottom opposite side, $\varnothing$ 1/2" air vent (E)

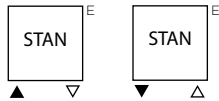

NB: The connection must be made in accordance with the required specifications

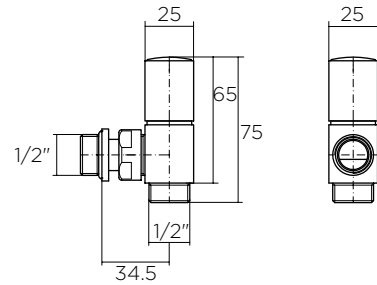

**RUNTAL HOTCUBE Kit**

Kit includes:

**Code HOTCUBE-KIT-790**

Pair of HOTCUBE valves chrome plated, pair of fittings for  $\varnothing$ 12/14 copper pipe, pair of fittings for  $\varnothing$  14 -10/16 -12 multilayer pipe. For fittings other than those provided, please refer to the valves prices list

# RUNTAL QUADRATO ACCESSORIES



Dual energy towel drying radiators continue to offer warmth and comfort throughout the home during summer months when the central heating system is not in use

## Kit LAMDA accessory for mixed operation:

The towel radiator in central heating version can be transformed in mixed operation class I with the corresponding immersion heater Kit LAMDA. It is advisable that the immersion heater is fitted on the return side of the radiator. The pipe centre will be reduced by 69\* mm. Chrome plated or white, T-piece included.

### Kit immersion heater LAMDA white

	<b>Watt</b>
Art. 857211	300
Art. 857221	600
Art. 857231	900

### Kit immersion heater LAMDA chrome

	<b>Watt</b>
Art. 857218	300
Art. 857228	600
Art. 857238	900

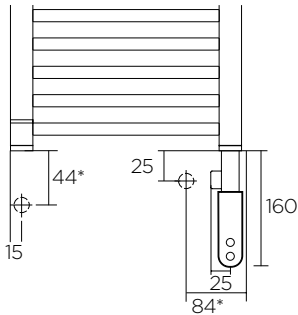

\* with runtal radval valve, this dimension varies according to the valve selected

## CHARACTERISTICS:

Mains voltage: 230 V, 50 Hz +/- 10 %  
 Nominal rating: 300, 600 Watt  
 Main connection: 1.0 m power cable without plug  
 Degree of protection: Class II IP44 with CE-marketing

## FUNCTIONS:

- Manual and programmable operation
- Manual adjustable medium temperature from 40-45°C
- Max. surface temperature ca 70°C
- With 2 hour timer for adjustable medium temperature from 50°C to 70°C and frost protection
- Programm variation with 24h interval

## ATTENTION:

To switch heating operations:

### FOR SUMMER USE:

- Switch off central heating
- Vent the radiator to ensure that there is no air present and make sure that the heating circuit is filled with water
- Close the flow valve (only)
- Activate the immersion heater as required

### FOR WINTER USE:

- De-activate the immersion heater
- Open the flow valve

Position of electrical connection

The electrical connection must be performed by an electrician in accordance with applicable regulations

# RUNTAL QUADRATO MOUNTING INSTRUCTIONS

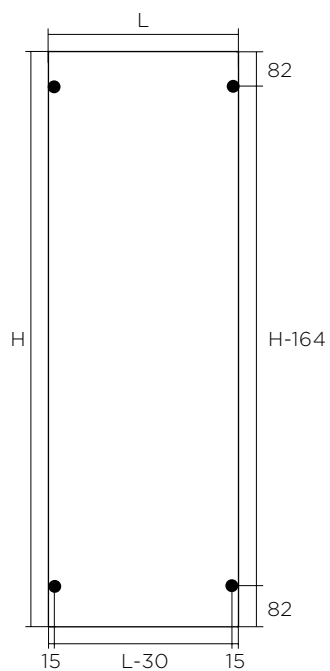

- H Height (mm)
- L Length (mm)
- Fixing point

For correct installation, please note the corresponding installation instructions



**ZEHNDER GROUP INTERNATIONAL SALES**

Almweg 34, DE-77933 Lahr  
T +49 7821 586-392, F +49 7821 586-406  
International.sales@zehndergroup.com  
www.runtal.com

A member company of the Zehnder Group.

