

RUNTAL VELUM

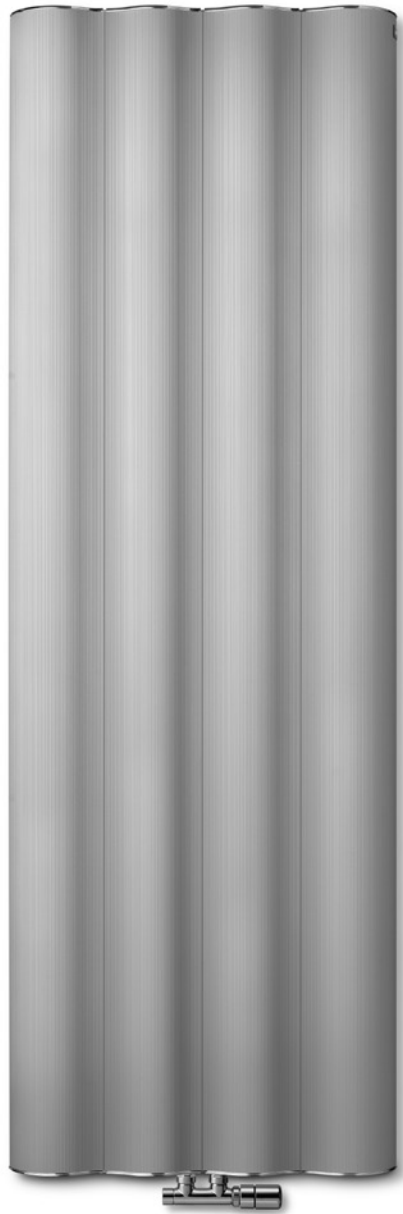
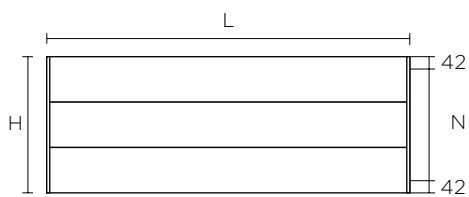

runtal

RUNTAL VELUM TECHNICAL SPECIFICATIONS

CENTRAL HEATING – HORIZONTAL MODEL



FRONT VIEW

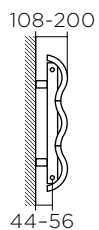

SIDE VIEW

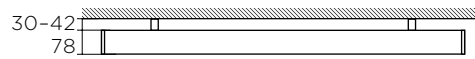

TOP VIEW

CENTRAL HEATING – VERTICAL MODEL

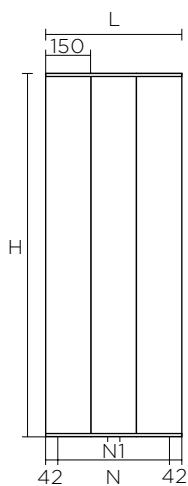

FRONT VIEW

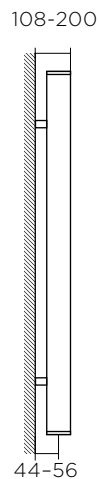

SIDE VIEW

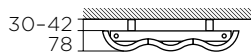

TOP VIEW

ELECTRIC OPERATION ONLY – VERTICAL MODEL

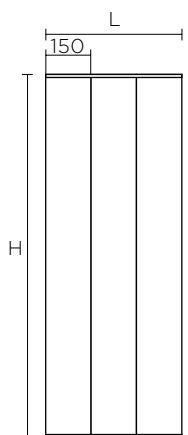

FRONT VIEW

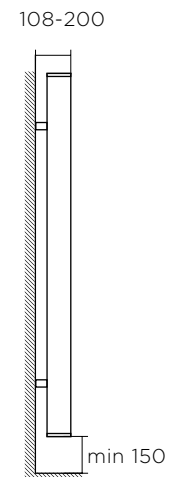

SIDE VIEW

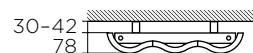

TOP VIEW

- N Pipe centres (mm)
- N1 Pipe centres (mm)
- L Width (mm)
- H Height (mm)

RUNTAL VELUM

CENTRAL HEATING – HORIZONTAL MODEL

Height 302 mm	Width mm	N mm	V dm ³	M kg	S _k %	q _{ms} kg/h	n	P ΔT 50K Watt
VELV-030-150	1510	218	0,87	8,60	39,1	43	1,257	496
VELV-030-180	1810	218	0,97	10,10	38,9	51	1,257	594
VELV-030-200	2010	218	1,03	11,10	38,8	57	1,257	660

Height 454 mm	Width mm	N mm	V dm ³	M kg	S _k %	q _{ms} kg/h	n	P ΔT 50K Watt
VELV-045-060	610	370	1,00	5,50	41,5	24	1,259	281
VELV-045-070	710	370	1,04	6,30	41,0	28	1,259	327
VELV-045-080	810	370	1,08	7,10	40,6	32	1,259	373
VELV-045-090	910	370	1,13	7,90	40,3	36	1,259	419
VELV-045-100	1010	370	1,17	8,70	40,1	40	1,259	465
VELV-045-120	1210	370	1,21	10,30	39,7	48	1,259	557
VELV-045-140	1410	370	1,31	11,90	39,5	56	1,259	649
VELV-045-150	1510	370	1,35	12,70	39,4	60	1,259	695
VELV-045-160	1610	370	1,40	13,50	39,3	64	1,259	741
VELV-045-180	1810	370	1,50	15,10	39,1	72	1,259	833
VELV-045-200	2010	370	1,59	16,70	39,0	80	1,259	925
VELV-045-220	2210	370	1,69	18,30	38,9	87	1,259	1017

Height 606 mm	Width mm	N mm	V dm ³	M kg	S _k %	q _{ms} kg/h	n	P ΔT 50K Watt
VELV-060-060	610	522	1,28	6,90	41,8	31	1,261	361
VELV-060-070	710	522	1,34	8,00	41,3	36	1,261	420
VELV-060-080	810	522	1,40	9,10	40,9	41	1,261	479
VELV-060-090	910	522	1,46	10,20	40,6	46	1,261	538
VELV-060-100	1010	522	1,52	11,30	40,3	51	1,261	597
VELV-060-120	1210	522	1,65	13,50	40,0	61	1,261	715
VELV-060-140	1410	522	1,78	15,70	40,0	72	1,261	833
VELV-060-150	1510	522	1,84	16,80	39,6	77	1,261	892
VELV-060-160	1610	522	1,90	17,90	39,5	82	1,261	952
VELV-060-180	1810	522	2,03	20,10	39,3	92	1,261	1070
VELV-060-200	2010	522	2,15	22,20	39,2	102	1,261	1188
VELV-060-220	2210	522	2,28	24,30	39,1	112	1,261	1306

N: pipe centres, V: volume, M: weight; S_k: radiation, q_{ms}: water flow, n: exponent, P ΔT 50K: EN 442 output

CENTRAL HEATING – HORIZONTAL MODEL

Height 758 mm	Width mm	N mm	V dm³	M kg	S_k %	q_{ms} kg/h	n	P ΔT 50K Watt
VELV-075-060	610	674	1,62	8,30	41,9	38	1,269	441
VELV-075-070	710	674	1,70	9,70	41,4	44	1,269	514
VELV-075-080	810	674	1,78	11,10	41,0	50	1,269	586
VELV-075-090	910	674	1,86	12,50	40,6	57	1,269	658
VELV-075-100	1010	674	1,94	13,90	40,4	63	1,269	731
VELV-075-120	1210	674	2,10	16,70	40,0	75	1,269	876
VELV-075-140	1410	674	2,26	19,50	39,7	88	1,269	1020
VELV-075-150	1510	674	2,33	20,90	39,6	94	1,269	1093
VELV-075-160	1610	674	2,41	22,30	39,5	100	1,269	1165
VELV-075-180	1810	674	2,57	25,10	39,4	113	1,269	1310
VELV-075-200	2010	674	2,72	27,85	39,2	125	1,269	1454
VELV-075-220	2210	674	2,88	30,60	39,1	137	1,269	1599

Height 910 mm	Width mm	N mm	V dm³	M kg	S_k %	q_{ms} kg/h	n	P ΔT 50K Watt
VELV-090-060	610	826	1,96	9,70	41,8	45	1,277	525
VELV-090-070	710	826	2,06	11,40	41,2	53	1,277	611
VELV-090-080	810	826	2,16	13,10	40,8	60	1,277	697
VELV-090-090	910	826	2,26	14,80	40,5	67	1,277	783
VELV-090-100	1010	826	2,36	16,50	40,2	75	1,277	869
VELV-090-120	1210	826	2,55	19,90	39,8	89	1,277	1041
VELV-090-140	1410	826	2,74	23,30	39,6	104	1,277	1213
VELV-090-150	1510	826	2,83	25,00	39,5	112	1,277	1298
VELV-090-160	1610	826	2,92	26,70	39,4	119	1,277	1385
VELV-090-180	1810	826	3,11	30,10	39,2	134	1,277	1557
VELV-090-200	2010	826	3,29	33,50	39,1	149	1,277	1729
VELV-090-220	2210	826	3,48	36,90	38,9	163	1,277	1901

N: pipe centres, V: volume, M: weight; S_k: radiation, q_{ms}: water flow, n: exponent, PΔT 50K: EN 442 output

CENTRAL HEATING – VERTICAL MODEL

Height 1210 mm	Width mm	N mm	N1 mm	V dm ³	M kg	S_k %	q_{ms} kg/h	n	P ΔT 50K Watt
VELH-120-30	302	218	50	0,77	7,20	36,4	37	1,275	430
VELH-120-45	454	370	50	1,21	10,50	35,9	53	1,278	616
VELH-120-60	606	522	50	1,65	14,00	36,0	68	1,280	794

Height 1510 mm	Width mm	N mm	N1 mm	V dm ³	M kg	S_k %	q_{ms} kg/h	n	P ΔT 50K Watt
VELH-150-30	302	218	50	0,87	9,50	36,6	46	1,275	530
VELH-150-45	454	370	50	1,35	13,00	36,0	65	1,281	759
VELH-150-60	606	522	50	1,84	16,80	36,1	84	1,288	979

Height 1810 mm	Width mm	N mm	N1 mm	V dm ³	M kg	S_k %	q_{ms} kg/h	n	P ΔT 50K Watt
VELH-180-30	302	218	50	0,97	11,00	36,8	54	1,274	628
VELH-180-45	454	370	50	1,50	15,10	36,2	77	1,285	899
VELH-180-60	606	522	50	2,03	20,20	36,3	100	1,295	1160

Height 2010 mm	Width mm	N mm	N1 mm	V dm ³	M kg	S_k %	q_{ms} kg/h	n	P ΔT 50K Watt
VELH-200-30	302	218	50	1,03	12,20	37,0	59	1,261	692
VELH-200-45	454	370	50	1,59	17,50	36,4	85	1,274	991
VELH-200-60	606	522	50	2,15	22,20	36,4	110	1,287	1278

N: pipe centres, N1: pipe centres, V: volume, M: weight; S_k: radiation, q_{ms}: water flow, n: exponent, PΔT 50K: EN 442 output

ELECTRIC ONLY VERSION – VERTICAL MODEL

Height 1210 mm	Width mm	M kg	EP Watt
VELHE-120-030/FF	302	8,0	400
VELHE-120-045/FF	454	11,2	600
VELHE-120-060/FF	606	14,2	800

Height 1510 mm	Width mm	M kg	EP Watt
VELHE-150-030/FF	302	9,0	500
VELHE-150-045/FF	454	13,5	750
VELHE-150-060/FF	606	16,5	1000

Height 1810 mm	Width mm	M kg	EP Watt
VELHE-180-030/FF	302	10,7	600
VELHE-180-045/FF	454	15,2	900
VELHE-180-060/FF	606	19,5	1200

M: weight, EP: electric power

FINISH

Finish powder-coated	Code	Extra charge on RAL 9016
White RAL9016 (standard)	0603	—
Classic and Trendy	See Runtal colour chart	15%
Metal Look (White Aluminium-0536 and Titane-0542 not available)	See Runtal colour chart	25%
White Quartz	0521	25%

TECHNICAL DATA

Materials	Aluminium profile 151mm, header Ø 38mm and round tubes Ø 12mm, made of steel, VELH/VELHE models with chrome-plated decorative covers, VELV models with white decorative covers or for radiators in special colour, chrome-plated
Operating pressure	Standard max. 4.0 bar (high pressure max. 10 bar, extra charge +15%)
Test pressure	Standard 5.2 bar
Operating temperature	Max. 120 °C
Standard kit	Wall brackets and air vent included in packaging
Valves	As per ACCESSORIES price list
Connections	RUNTAL VELUM radiators work on the forced-flow principle and are fitted with the necessary baffles in the factory. They must only be connected in accordance with the drawings below.

VELH (vertical models): ½" internal thread for flow ▲ / return ▼, ½" air vent (E)

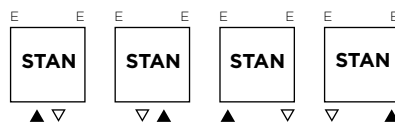

VELV (horizontal models): ½" internal thread for flow ▲ / return ▼, ½" air vent (E)

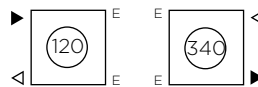

Min. water flow q_m min.	The price list data tables show the standard water flow q_{ms} for each model. The actual water flow q_m as a percentage of the standard water flow q_{ms} should normally be at least 17% for the RUNTAL VELUM VELH and 27% for the horizontal RUNTAL VELUM VELV
----------------------------	---

Pressure loss Δp	The pressure loss Δp [hPa] is calculated using the formula: (incl. inlet and outlet resistance, q_m in kg/h) $\Delta p = q_m^{1.8227} \cdot 0.00134$
--------------------------	--

Single-pipe systems	Not possible
---------------------	--------------

Standards	CE, EN 442
-----------	------------

Electric-only model F

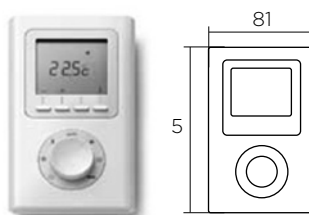

- Control unit
- Room temperature control
 - Daily and weekly programme
 - Operating modes: frost protection
 - Economy programme, comfort, automatic, manual, off
 - Wall-mounted or free-standing

Mains voltage: 230 V, 50 Hz +/- 10%
Mains connection: 2.0 m power cable with 2 pole Euro plug T11
Degree of protection: Class II IP44 (splash water) with CE-marking

Position of electrical connection	The electrical connection must be performed by an electrician in accordance with applicable regulations
-----------------------------------	---

RUNTAL VELUM ACCESSORIES



CHROME-PLATED TOWEL BAR, Ø 14mm

For retrofitting at any height. More than one towel bar can be fitted per radiator.
Use: RUNTAL VELUM VELH (vertical models).

Art. no.	L ⁽¹⁾ mm	L ⁽²⁾ mm	Finish
468008	302	364	Chrome-plated
468018	454	516	Chrome-plated
468028	606	668	Chrome-plated

(L⁽¹⁾) Width of radiator, (L⁽²⁾) Width of towel bar

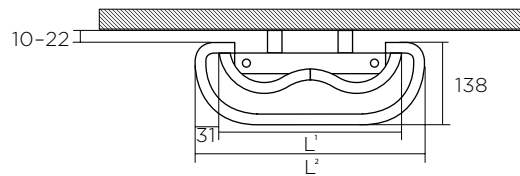

TOP VIEW 468008

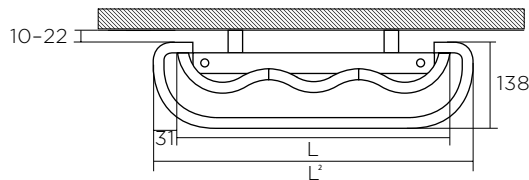

TOP VIEW 468018

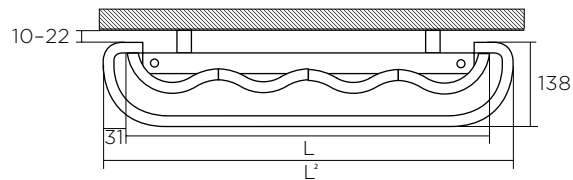

TOP VIEW 468028

RUNTAL VELUM MOUNTING INSTRUCTIONS

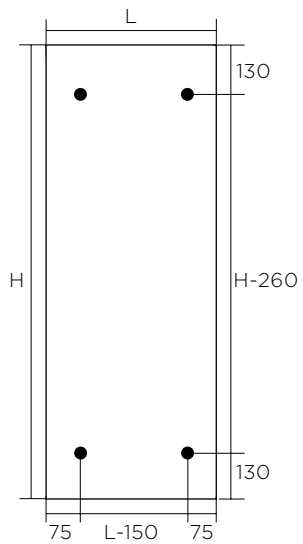

**VELH/VELHE
(VERTICAL MODELS)**

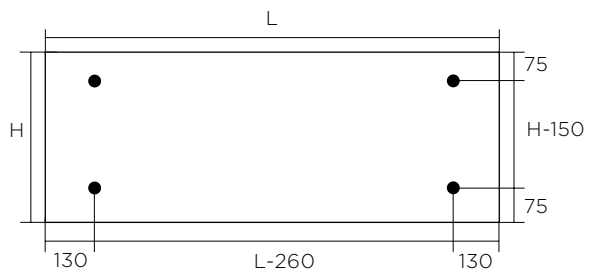

**VELV
(HORIZONTAL MODELS)**

- H Height (mm)
- L Width (mm)
- Fixing point

For correct radiator installation, please note the corresponding installation instructions

ZEHNDER GROUP INTERNATIONAL SALES

Almweg 34, DE-77933 Lahr
T +49 7821 586-392, F +49 7821 586-406
International.sales@zehndergroup.com
www.runtal.com

A member company of the Zehnder Group.

